

PARTS CATALOG

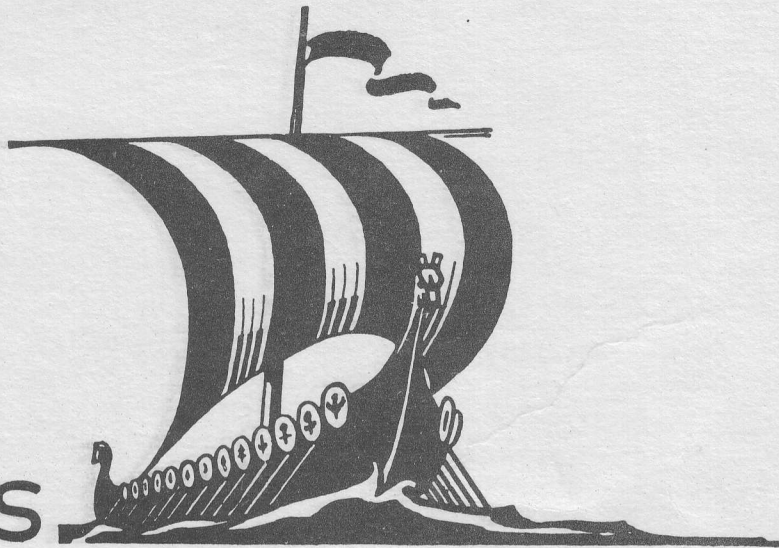

EATON'S

VIKING

OUTBOARD MOTORS

5.0 O. B. C. CERTIFIED BRAKE HORSE-
POWER AT 4000 R. P. M.

Deluxe Twin Cylinder
Model No. 5D10V

ALWAYS GIVE COMPLETE MOTOR
MODEL NUMBER WHEN ORDERING
PARTS-

Manufactured expressly for

THE T. EATON CO. LIMITED

by

OUTBOARD MARINE CORPORATION OF CANADA LTD.
PETERBOROUGH CANADA

Part No. 401790

WARRANTY

We warrant each new outboard motor of our manufacture to be free from defects in material and workmanship under normal use and service, our obligation under this warranty being limited to making good at the factory any part or parts thereof which shall, within three (3) months after delivery of such motor to original purchaser, be returned to us with transportation charges prepaid, and which our examination shall disclose to have been defective; this warranty being expressly in lieu of all other warranties expressed or implied and of all other liabilities in connection with the sale or use of any motors.

This warranty shall not apply to any motor which shall have been repaired or altered outside the factory in any way so as to affect its stability, nor which has been subject to misuse, negligence or accident. Warranty is void if motor is used for racing purposes.

We make no warranty in respect to trade accessories not of our manufacture; inasmuch as they are usually warranted separately by their respective manufacturers.

Because of the usual strains and accidents to which such products may be subjected, we make no warranty of either material or workmanship in racing outboard motors or any of our products when used for racing.

Parts believed to be defective should be returned to us for inspection and replacement. Be sure to state motor model and serial number and date of purchase.

ORDER BY PART NUMBER AND NAME GIVING MOTOR MODEL AND SERIAL NUMBER

CARBURETOR PARTS

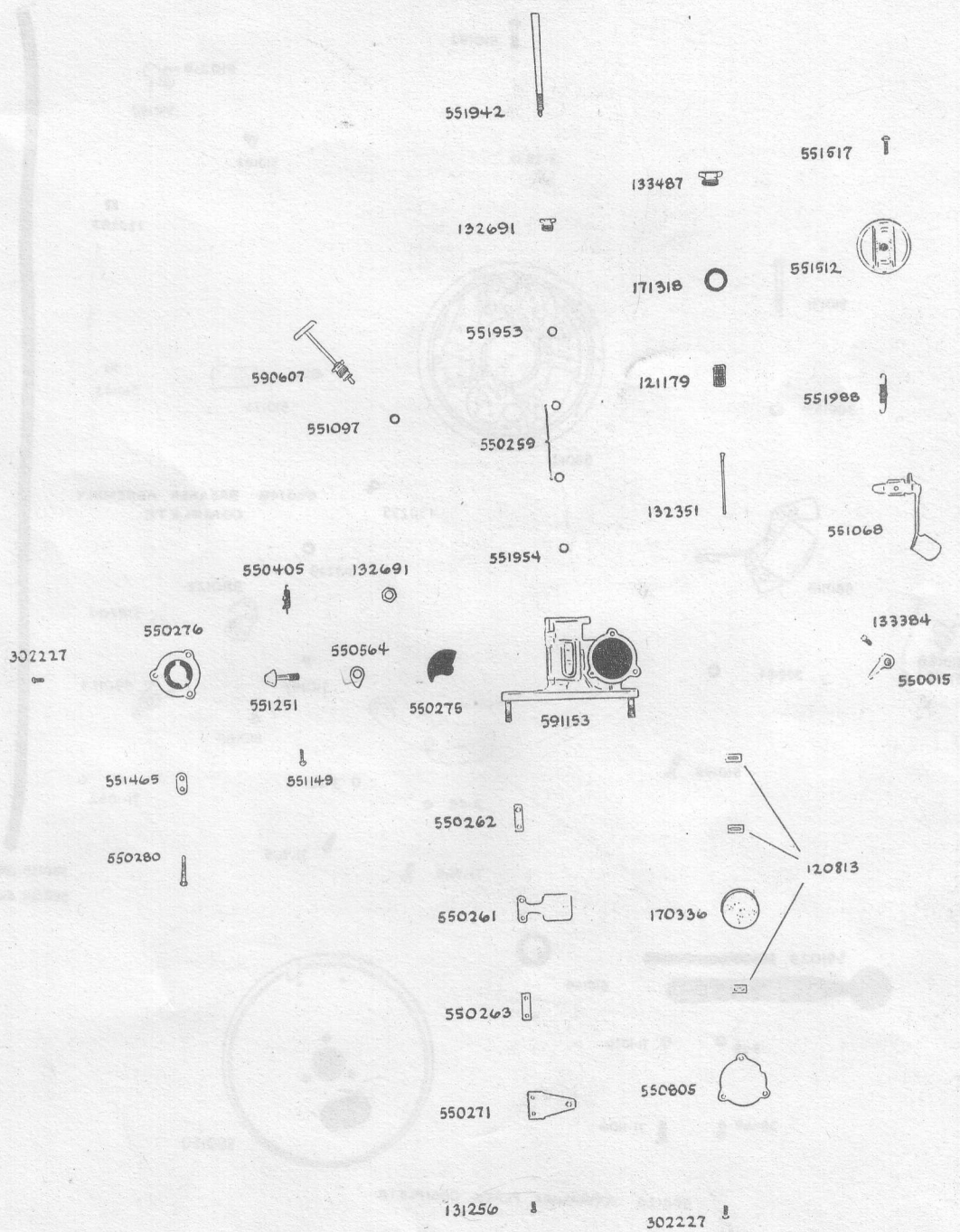

591-183 CARBURETOR ASSEMBLY COMPLETE

ORDER BY PART NUMBER AND NAME GIVING MOTOR MODEL AND SERIAL NUMBER

MAGNETO PARTS

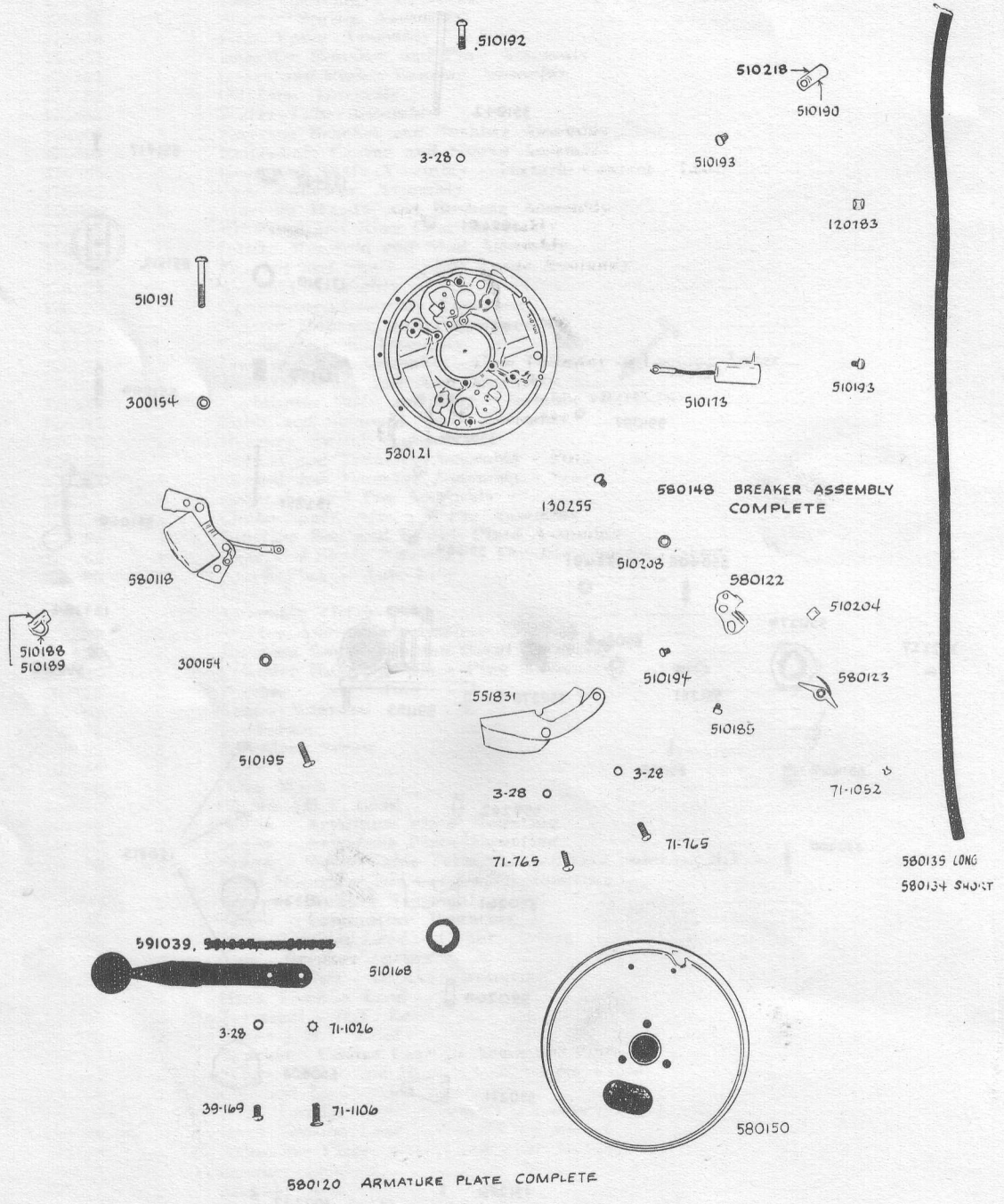

ORDER BY PART NUMBER AND NAME GIVING MOTOR MODEL AND SERIAL NUMBER

POWER HEAD PARTS

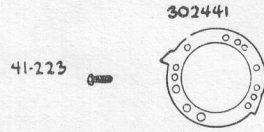

302441

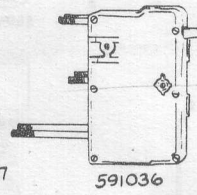
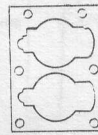
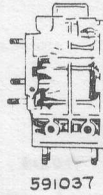
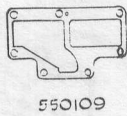
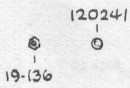
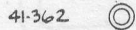
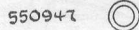
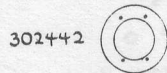
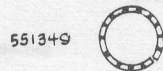

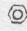
301988 
120395 KEY

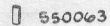
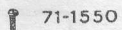
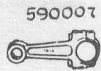

ORDER BY PART NUMBER AND NAME GIVING MOTOR MODEL AND SERIAL NUMBER

LOWER UNIT PARTS—UPPER

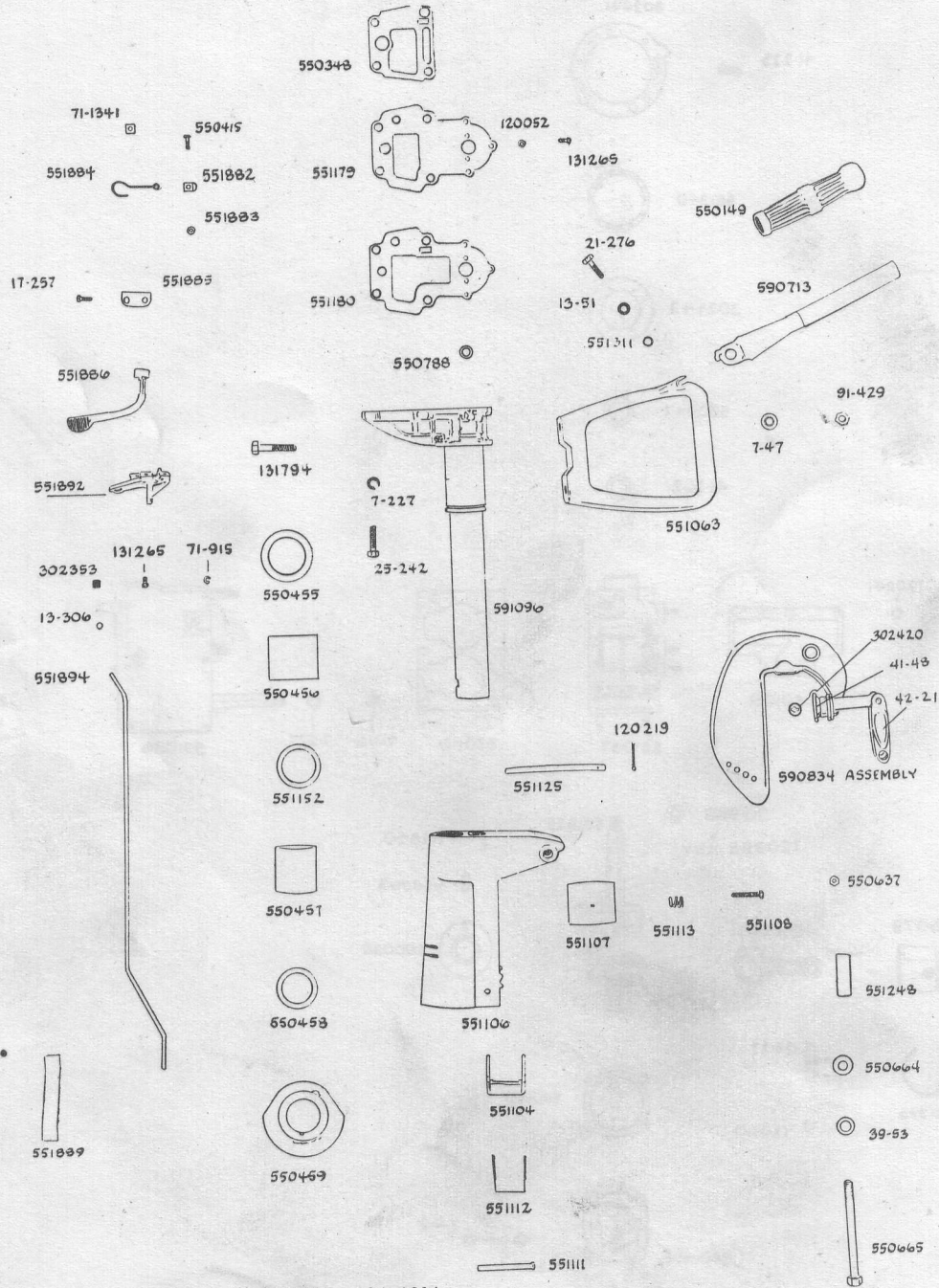

590620 PIVOT BEARING AND REVERSE LOCK ASSY

ORDER BY PART NUMBER AND NAME GIVING MOTOR MODEL AND SERIAL NUMBER

LOWER UNIT PARTS — GEARCASE

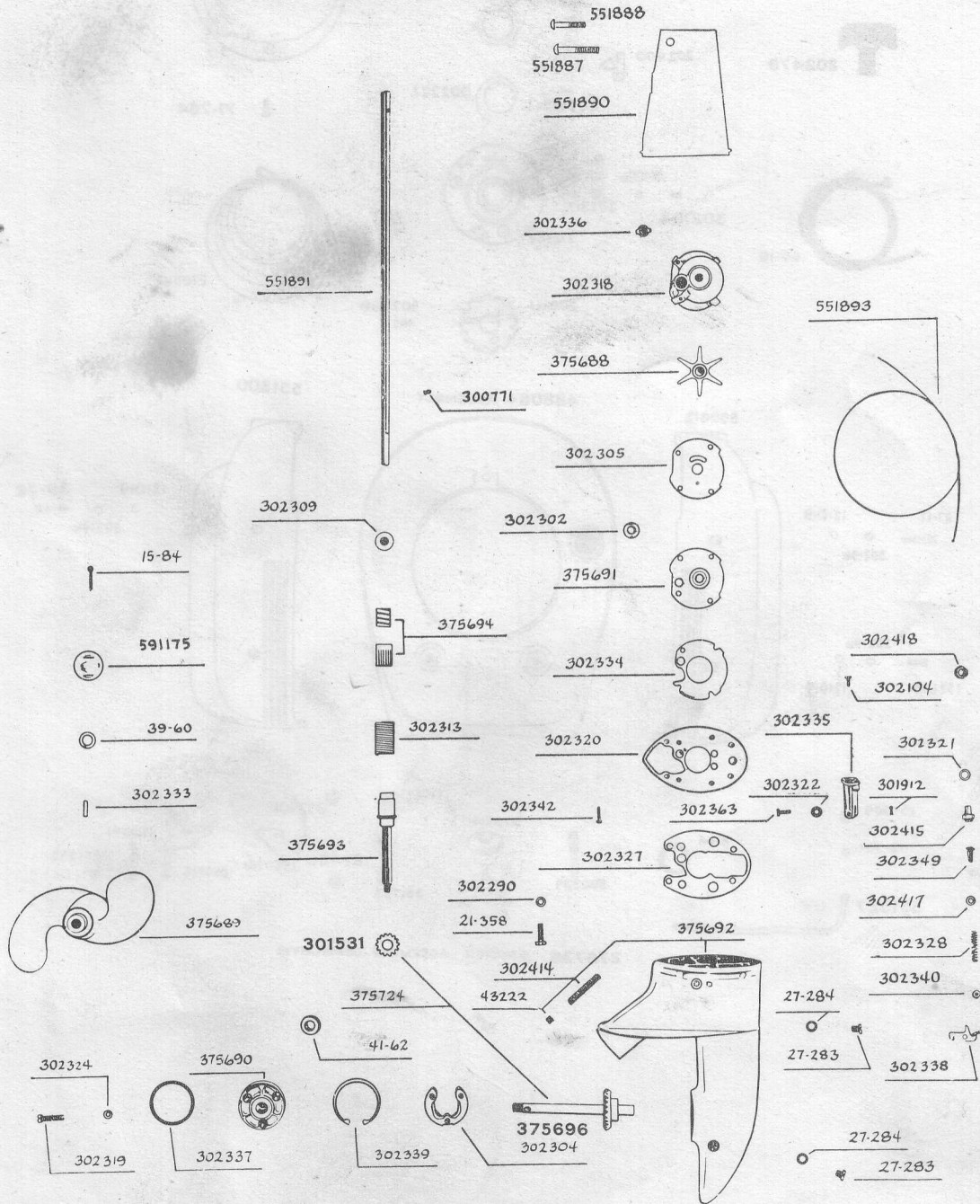

551206

551204

551205



202479



44-19

131991



202349



202356



276643



202114



202470



202155



302222

71-1026



302104

202317



276589

202111



302468

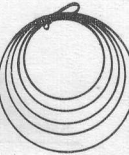

276510

276739

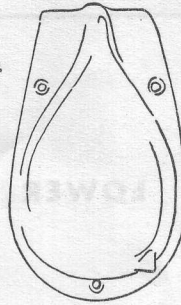

71-764



71-764



71-764

486084 ASSEMBLY

550812

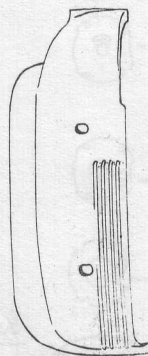

27-17



121019



302196

302196

132679

121019

551500

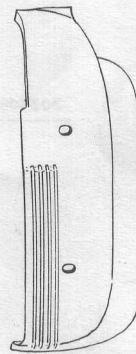

121019



39-72



302196

13-305



13-304



5-48



590334



375514



120241



302401

21-165



550716



120241



551232

551527



276738 STARTER ASSEMBLY COMPLETE

PARTS LIST

ORDER BY PART NUMBER AND NAME GIVING MOTOR MODEL & SERIAL NUMBER

<u>Part No.</u>	<u>Description</u>	<u>Part No.</u>	<u>Description</u>
3-28	Lockwasher-cam & handle to plate	71-1026	Lockwasher
5-48	Gasket-filler cap	71-1052	Spring clip
7-46	Nut-lower bearing & cylinder to crankcase	71-1106	Screw-handle to plate
7-47	Lockwasher-carrying handle to lower unit screw	71-1341	Square nut-control cable spring to bracket
7-227	Lockwasher	71-1487	Lockwasher-cover plate screw
13-51	Lockwasher-steering handle to carrying handle screw	71-1550	Screw-crankcase to centre bearing
13-304	Gland	91-429	Nut-carrying handle to lower unit screw
13-305	Nut-gas line	120110	Clip ring-piston wrist pin
13-306	Gland-control cable tube	120219	Cotter pin-adjusting pin
15-84	Cotter pin-propeller nut	120241	Lockwasher
17-257	Screw-spring-control lever bracket	120395	Key-crankshaft
19-136	Nut-carburetor to crankcase	120783	Marker-high tension lead
21-165	Washer-gas tank mounting	120813	Float lock-carburetor
21-276	Screw-steering handle to carrying handle	121019	Lockring-motor cover screws
21-358	Screw-upper to lower g'case	121179	Screen-strainer
25-27	Piston wrist pin	130255	Screw-breaker mounting
25-242	Screw-powerhead to lower unit	130450	Nut-control cable spring
27-283	Screw-grease plug	131256	Screw
27-284	Washer-grease plug	131265	Screw
39-53	Washer-tilting bolt	131794	Screw-carrying handle to lower unit
39-60	Lockwasher-propeller nut	131991	Screw-hub to housing
39-72	Screw-motor cover	132351	Inlet needle
39-169	Screw-handle to plate	132691	Gland
41-48	Swivel plate-clamp screw	133384	Set screw
41-62	Seal-gearcase head to propeller shaft	133487	Plug-strainer
41-223	Screw-support plate	170336	Float
41-333	Piston ring	171318	Gasket-plug
41-362	Oil slinger	200322	Spark plug
42-21	Clamp screw-stern bracket	202111	Ratchet-starter
43-222	Plug-gearcase	202114	Equalizer cup
44-19	Starter rope & anchor assy.	202155	Pawl spring
71-764	Screw-starter housing	202317	Retainer-starter pawl
71-765	Screw-cam to plate	202349	Lockwasher
71-915	Lockwasher	202356	Washer-starter spindle
		202470	Pawl-starter
		202479	Starter handle

ORDER ALL PARTS FROM NEAREST PARTS DISTRIBUTOR OR DEALER

PARTS LIST

ORDER BY PART NUMBER AND NAME GIVING MOTOR MODEL & SERIAL NUMBER

<u>Part No.</u>	<u>Description</u>	<u>Part No.</u>	<u>Description</u>
276510	Spring-starter	302342	Screw-plate to impeller housing
276589	Starter pulley assembly	302349	Grommet-seal-control cable-lower
276643	Spindle & pin assembly-starter	302353	Nut-control cable tube
276738	Starter assembly complete	302363	Pivot pin-clutch lever
276739	Starter housing assembly	302401	Washer-gas tank mounting
300154	Washer	302414	Screen-water intake
300771	Pin-driveshaft to impeller	302415	Use 302419
301531	Pinion gear	302417	Washer-grommet to clutch lever spring
301912	Cotter pin-pivot pin	302418	Nut-guide screw
301988	Nut-flywheel	302419	Guide screw-control screw
302104	Screw-plate to clutch lever bracket & retainer	302420	Retainer-swivel plate
302196	Washer-motor cover screw	302441	Support-armature plate
302222	Friction spring	302442	Retaining ring
302227	Screw	302468	Screw-ratchet to flywheel
302290	Lockwasher-upper to lower gearcase screw	375079	Piston & dowel pin assy.
302302	Seal-bearing housing	375514	Gas tank filler cap assy.
302304	Nut plate-gearcase head	375688	Impeller & insert assy.
302305	Plate-impeller housing	375690	G'case head & bearing assy.
302309	Retainer-clutch	375691	Bearing housing and bearing assembly
302313	Spring-clutch	375692	G'case lower & plug assy.
302318	Impeller-housing	375693	Pinion shaft & clutch pilot assembly
302319	Screw-gearcase head	375694	Spring & sleeve assembly-shock absorber
302320	Plate-lower to upper gearcase	375696	Propeller shaft and gear
302321	Gasket-plate to seal hsg.	375724	Propeller shaft, gear & pinion assembly
302322	Bow washer-pivot pin-clutch lever	486087	Gas tank & transfer assy.
302324	Washer-g'case head screw	510168	Cam-magneto
302327	Gasket-lower g'case to plate	510173	Condenser
302328	Spring-clutch lever	510185	Eccentric-breaker
302333	Propeller drive pin	510188	Oiler clip
302334	Gasket-bearing housing to plate	510189	Oiler wick
302335	Bracket-clutch lever	510190	Clamp-high tension lead-long
302336	Grommet-water tube to impeller housing	510191	Screw-armature plate mounting
302337	O ring-gearcase head	510192	Screw-armature plate mounting
302338	Lever-clutch		
302339	Retaining ring-gearcase lower		
302340	Washer-spring to clutch lever		

ORDER ALL PARTS FROM NEAREST PARTS DISTRIBUTOR OR DEALER

PARTS LIST

ORDER BY PART NUMBER AND NAME GIVING MOTOR MODEL & SERIAL NUMBER

Part No.	Description	Part No.	Description
510193	Screw-condenser & high tension lead mounting	551063	Carrying handle
510194	Screw-breaker terminal	551068	Primer lever
510195	Screw-lamination mounting	551097	Packing-carburetor shut-off needle
510204	Spring clip-breaker	551104	Reverse lock
510208	Bow washer-breaker mtg.	551106	Pivot bearing
510218	Clamp-high tension lead-short	551107	Clamp-shock absorber
550015	Cam-primer	551108	Screw-clamping
550037	Crankcase gasket	551111	Pin-reverse lock
550063	Locating dowel	551112	Spring-reverse lock
550109	Gasket-carburetor	551113	Spring-shock absorber clamp
550116	Gasket-cylinder to c'case	551125	Pin-bracket adjusting
550149	Grip-steering handle	551149	Cotter pin
550259	Packing-adjusting needle	551152	Seal ring
550261	Reed-lower	551179	Manifold cover plate
550262	Spacer	551180	Gasket-manifold cover
550263	Binding plate-reed	551204	Clamp-starter handle
550271	Reed-upper	551205	Clamp-starter handle
550275	Valve-throttle	551206	Screw-starter handle clamp
550276	Cover-valve	551232	Nut-tank bracket
550280	Screw-adjusting	551248	Spacer-tilting bolt
550348	Gasket-lower unit to power head	551251	Throttle lever
550405	Spring	551311	Bushing-steering handle
550415	Screw-control cable spring	551349	Wave washer
550455	Thrust washer-upper	551465	Friction plate-carburetor adjusting
550456	Bushing-upper pivot bearing	551512	Knob-carburetor control
550457	Bushing-lower pivot bearing	551517	Screw-carburetor knob
550458	Thrust washer-lower	551527	Gas line
550564	Spring holding lug	551793	Screw-gas tank to bracket and flange
550637	Nut-tilting bolt	551829	Crankshaft
550664	Washer-tilting bolt	551831	Cam-throttle
550665	Bolt-tilting	551882	Clamp-control cable
550715	Bracket-gas tank-right hand	551884	Spring-control cable
550716	Bracket-gas tank-left hand	551885	Spring-control lever
550788	Water seal-driveshaft-upper	551886	Control lever
550805	Cover-bowl	551887	Screw-clamp-gearcase
550826	Motor cover-port	551888	Screw-gearcase to manifold tube
550827	Motor cover-starboard	551889	Water tube
550947	Oil retainer	551891	Driveshaft
		551892	Bracket-control lever

ORDER ALL PARTS FROM NEAREST PARTS DISTRIBUTOR OR DEALER

PARTS LIST

ORDER BY PART NUMBER AND NAME GIVING MOTOR MODEL & SERIAL NUMBER

<u>Part No.</u>	<u>Description</u>	<u>Part No.</u>	<u>Description</u>
551893	Control cable-clutch	590035	Centre bearing assembly
551894	Tube-control cable	590334	Screen assembly
551942	Needle-adjusting	590484	Lower bearing & drain tube assembly
551953	Washer-high speed needle	590607	Carburetor shut-off needle assembly
551954	Spacer-high speed needle	590713	Steering handle assembly
551988	Spring-primer lever	590834	Stern bracket assembly
580118	Coil & lamination assy.	591036	Cylinder & covers assy.
580120	Armature plate assembly	591037	Crankcase & stud assy.
580121	Armature plate & post assy.	591087	Armature plate handle
580122	Breaker base assembly	591096	Manifold & tube assembly
580123	Rocker arm assembly	591153	Carburetor body & stud assembly
580134	High tension lead assy. - upper	591169	Propeller & bushing assy.
580135	High tension lead assy. - lower	591170	Pump hsg. & screw assy.
580148	Breaker assy. complete	591175	Propeller nut assembly
580150	Flywheel	591183	Carburetor assembly
590007	Connecting rod assembly		

MISCELLANEOUS PARTS NOT ILLUSTRATED

<u>Part No.</u>	<u>Description</u>
401525	Transfer - gas tank - right hand
401526	Transfer - gas tank - left hand
401527	Transfer - start and stop
551573	Transfer - prime - star. cover
551594	Transfer - lean - port cover
552005	Transfer - neutral range - star. cover
590457	Tool kit
486027	Basic gasket set

ORDER ALL PARTS FROM NEAREST PARTS DISTRIBUTOR OR DEALER